



**NVC**®



***IP65 Fluorescent Fitting***  
***WATERPROOF BATTENS***



- ***IP65***
- ***Easy Installation***
- ***Energy Saving***

## CONSTRUCTION:



## OPTIONS:

- T8 & T5 single and twin lamp versions available;
- Stainless steel diffuser clips available separately;
- Integral emergency available of 3 hour duration;

## SPECIFICATION

- IP65 rated. Dust tight and water jet proof;
- High frequency electronic or magnetic(T8) gear as standard;
- For T8/T5 lamps. Supplied excluding lamps.

## PHOTOMETRIC DATA:

Model:NDL492/2x18W

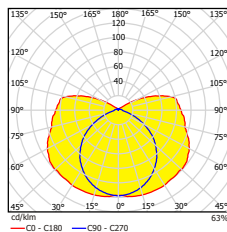

Utilisation factor/TM5

Reflectances			Room Index								
C	W	F	0.75	1.0	1.25	1.5	2.0	2.5	3.0	4.0	5.0
70	50	20	32	37	42	45	50	54	56	60	62
	30	26	31	36	40	45	49	52	56	59	
	10	22	27	32	35	41	45	48	52	56	
50	50	20	30	34	38	42	46	49	51	55	57
	30	25	29	34	37	42	45	48	51	54	
	10	21	25	30	33	38	42	45	49	51	
30	50	20	27	31	35	38	42	45	47	50	52
	30	23	27	31	34	38	42	44	47	50	
	10	20	24	28	31	35	39	41	45	48	
0	0	0	17	21	24	27	30	34	36	39	41
BZ-class	6	6	6	6	6	6	6	6	6	6	6

IP65 Fluorescent Fitting

## DIMENSIONS:

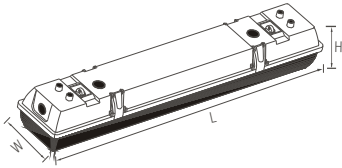

Model	L(mm)	W(mm)	H(mm)	CTN Dimension	QTY/ctn
<b>NDL491/1x18W-T8</b>	670	105	107	695x225x375	10
<b>NDL491/1x36W-T8</b>	1270	105	107	1295x225x235	6
<b>NDL491/1x58W-T8</b>	1570	105	107	1595x225x235	6
<b>NDL492/2x18W-T8</b>	670	165	107	695x345x305	8
<b>NDL492/2x36W-T8</b>	1270	165	107	1295x180x305	4
<b>NDL492/2x58W-T8</b>	1570	165	107	1595x180x305	4

Model	L(mm)	W(mm)	H(mm)	CTN Dimension	QTY/ctn
<b>NDL493/1x14W-T5</b>	620	70	83	635x325x350	16
<b>NDL493/1x28W-T5</b>	1210	70	83	1240x330x270	12
<b>NDL493/1x35W-T5</b>	1570	86	95	1595x290x300	9
<b>NDL494/2x14W-T5</b>	620	104	83	635x345x350	12
<b>NDL494/2x28W-T5</b>	1210	101	83	1245x230x350	8
<b>NDL494/2x35W-T5</b>	1515	101	83	1540x240x320	8

## LAMP OPTIONS

INPUT: AC220~240V 50Hz/60Hz

18W, 36W, 58W T8 fluorescent-G13 cap



14W, 28W, 35W T5 fluorescent-G5 cap



Model	Lamp	Base	Lamp shape	Control Gear
<b>NDL491/1x18W-T8</b>	T8	G13		Electronic / Magnetic
<b>NDL491/1x36W-T8</b>	T8	G13		Electronic / Magnetic
<b>NDL491/1x58W-T8</b>	T8	G13		Electronic / Magnetic
<b>NDL492/2x18W-T8</b>	T8	G13		Electronic / Magnetic
<b>NDL492/2x36W-T8</b>	T8	G13		Electronic / Magnetic
<b>NDL492/2x58W-T8</b>	T8	G13		Electronic / Magnetic
<b>NDL493/1x14W-T5</b>	T5	G5		Electronic
<b>NDL493/1x28W-T5</b>	T5	G5		Electronic
<b>NDL493/1x35W-T5</b>	T5	G5		Electronic
<b>NDL494/2x14W-T5</b>	T5	G5		Electronic
<b>NDL494/2x28W-T5</b>	T5	G5		Electronic
<b>NDL494/2x35W-T5</b>	T5	G5		Electronic



CE Mark is a statement by the manufacturer that the product complies with all relevant European directives and standards



Equipment must be earthed



Suitable for direct mounting on normally flammable surfaces



Protected against low pressure jets of water

**IP65 Fluorescent Fitting**

## APPLICATIONS:



## About NVC Lighting

NVC Lighting Technology Corporation is now the largest lighting manufacturer in China. We have a broad range of products for professional and domestic use, supported by extensive research, development and manufacturing facilities.,

Our product ranges includes commercial, office, outdoor and residential lighting, plus lamps and gear and a full range of electrical accessories. NVC was founded in 1998 and quickly became famous for its quick reactions to market changes. Such reactions resulted in a consistent and rapid growth in sales, which reached 600 million USD in 2009.

We have now started to market our products under the NVC brand outside China. Operating through a network of 1500 distributors and 2500 exclusive retail outlets in China and overseas NVC is now active throughout Asia, the Middle East, Africa, Europe, Australia and Latin America.

Thanks to investment in 2006 from Softbank & Goldman Sachs, and our recent flotation on the Hong Kong stock exchange, NVC has been able to recruit senior figures from the lighting industry and elsewhere to build a strong management team. This, coupled with a solid capital structure, has enabled NVC to accelerate its rate of business development both in China and overseas.



### NVC LIGHTING TECHNOLOGY CORPORATION

Add: NVC Industrial Park, Ruhu, Huizhou, Guangdong, P.R. China 516021

Tel: +86-752-2786890 2786891 2786887

Fax: +86-752-2786892 2786689

E-mail: [oversea01@nvc-lighting.com](mailto:oversea01@nvc-lighting.com) [oversea20@nvc-lighting.com](mailto:oversea20@nvc-lighting.com)

Http: [www.nvc-lighting.com](http://www.nvc-lighting.com)

50001472